

# PORT LED

REV.02.11.10  





Wet Location Junction Box  
 Supplied by Electrician



Uplight with Hexcell Louver

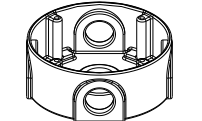
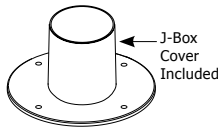
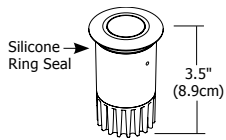

Step Light with  
 Micro Louver Steplight Kit #PORT-LL



Wet location Round Junction Box  
 Supplied by Electrician

OR

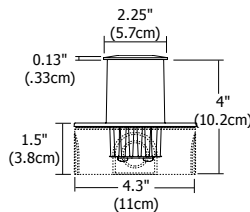

Indoor Octagon Junction Box  
 Supplied by Electrician

## Description:

Extremely slim and recessed, with an integral 12VAC 2.4 watt, high-powered, warm white LED, the fixture features a 16 degree precise focus, tempered glass lens with a marine-grade aluminum, round or square, beveled edge trim. The Port LED is rated for outdoor using a wet location electrical box or indoor using a standard octagon electrical box. The aluminum housing dissipates heat and allows the LED to operate at its optimum working temperature, thus giving the LED a stable light output and long lifetime. The trim accepts any color of Rosco or Lee color filter gels. Compatible remote power supplies are TE-60L-12, T-150-12 or T300-12.

## Finish:

Satin Aluminum

## Lamp Specification:

**LED** - 2.4W Warm White, 3000K, 82CRI

Add a warming filter to bring the color to 2500K

## Remote Power:

Use Electronic TE-60L-12, Magnetic T-150-12, T-300-12

## Dimmer:

Visit [www.edgelighting.com](http://www.edgelighting.com) for updates

## Weight:

1 lb (.45 kg)

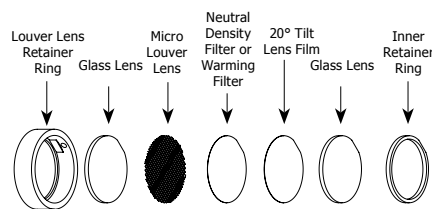

STEP LIGHT KIT  
 PORT-LL

Description		Trim		Finish		ACCESSORY CODE		Description		
<b>PORT</b>	-	<b>RD</b>	-	<b>ST</b>	-	<b>SA</b>	-	<b>PORT</b>	-	<b>LL</b>
<b>PORT</b> Port Step Light Kit		<b>RD</b> Round Square		<b>ST</b> Surface Trim		<b>SA</b> Satin Aluminum		<b>PORT</b> Port Step Light Kit		<b>LL</b> 1" Louver with 20° Beam Tilt Lens, Neutral Density Filter, Warming Filter

PROJECT:

FIXTURE TYPE:

DATE: