

## Installation Instructions for Puck LED

### IMPORTANT INFORMATION

- This product can be installed as recessed or surface mount.
- The Puck light can be powered and dimmed along with Soft Strips using the 12VDC, TEB-60L-12DC or TEB-60L-12DC-P, power supply and electronic low voltage dimmer. It can also be powered and dimmed using the 12VAC, TE-60L-12 or TE-60L-12-P power supply and electronic low voltage dimmer. Some flickering may occur on lower level of the light.
- It is recommended to use the HUB-4P or HUB-8P to power the Puck Lights.
- This installation instruction shows typical installation.

**SAVE THESE INSTRUCTIONS!**

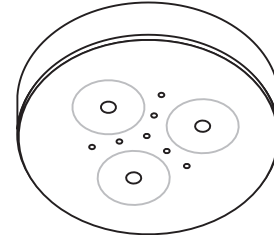

### Recessed Mount Installation

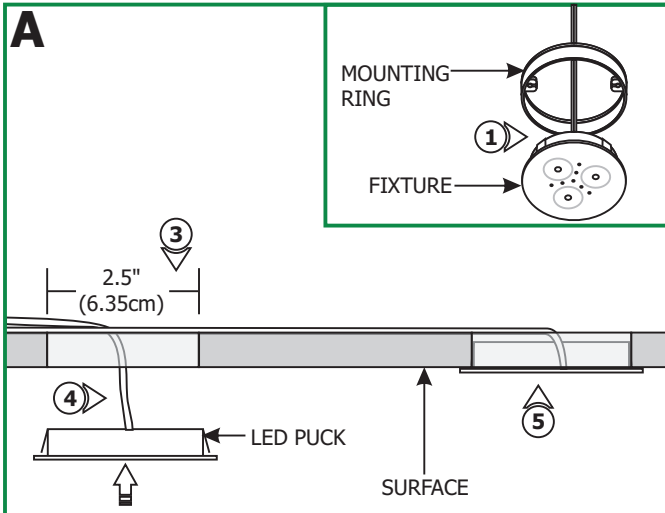

**NOTE:** Omit the steps below if surface mounting the Puck Lights.

- 1: Remove the mounting ring and discard it.
- 2: Mark the location where the LED Puck light is going to be recessed.
- 3: Drill out the marked location with a 2.5" circular saw.
- 4: Feed the LED Puck light wires through the cut out hole and snap the LED Puck light into the hole.
- 5: Repeat the steps 1 through 4 for the remaining pucks and then follow the "Power the Puck Lights" steps.

### Surface Mount Installation

- 1: Remove the mounting ring.
- 2: Use the mounting ring as a template to mark the screw location where the LED Puck light is going to be installed.
- 3: Use a 1/16" drill bit to drill pilot holes on marked locations.
- 4: Feed the LED Puck wires through the mounting ring. Hold the cord against the notch on the mounting ring while installing the mounting ring to the pilot holes with the provided two Phillips screws.
- 5: Pull the cord through the notch on the mounting clip and snap the LED puck light into the mounting ring.
- 6: Repeat the steps 1 through 5 for the remaining pucks and then follow the "Power the Puck Lights" steps.

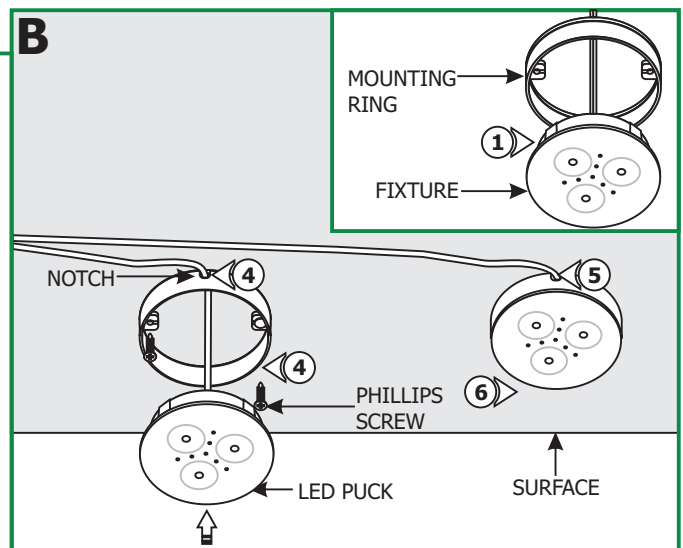

# Power the Puck Lights

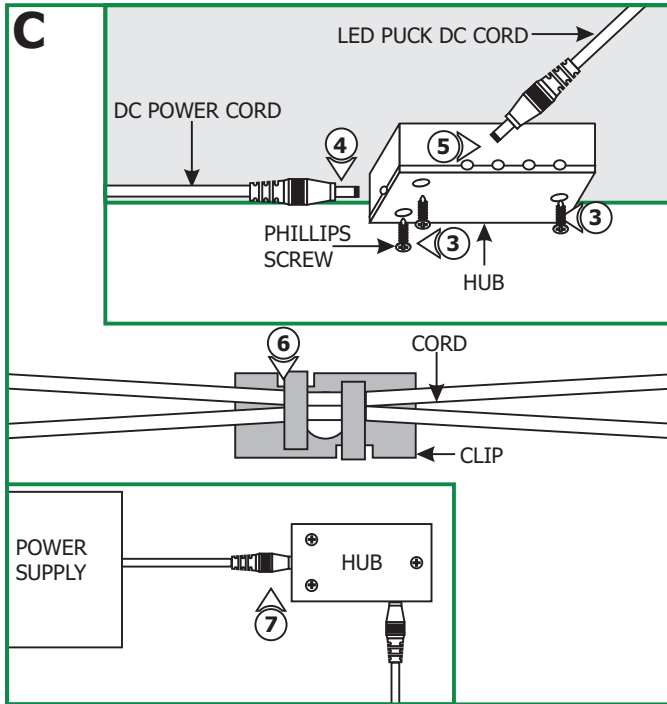

- 1: Mark the location where the hub is going to be installed.
- 2: Use a 1/16" drill bit to drill pilot holes on marked locations.
- 3: Mount the hub to the pilot holes with the three Phillips screws provided.
- 4: Connect the DC Power cord into the single port of the hub.
- 5: Connect each LED Puck DC cord into one port.
- 6: Use the provided clips to manage the Pucks and Hub cords.
- 7: Connect the Hub DC power cord to the 12 volt power supply wires. Refer to the instructions provided with the power supply.

**NOTE:** Each Puck contains three 1 watt LEDs consuming a total of 3 watts.

## TYPICAL WIRING DIAGRAM

