

## Installation Instructions for Halo Round & Square

### IMPORTANT INFORMATION

- This product is ETL listed for indoor dry locations.
- This product is wall mounted only.
- This product can mount to either a 4" square electrical box with round plaster ring or an octagon electrical box.
- This product is not dimmable.

**SAVE THESE INSTRUCTIONS!**

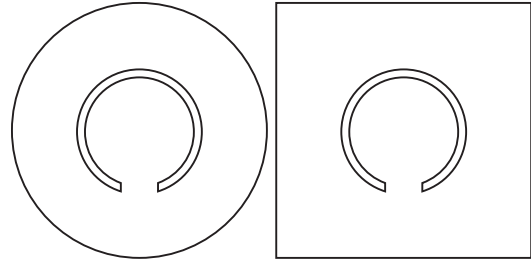

## Install the Fixture

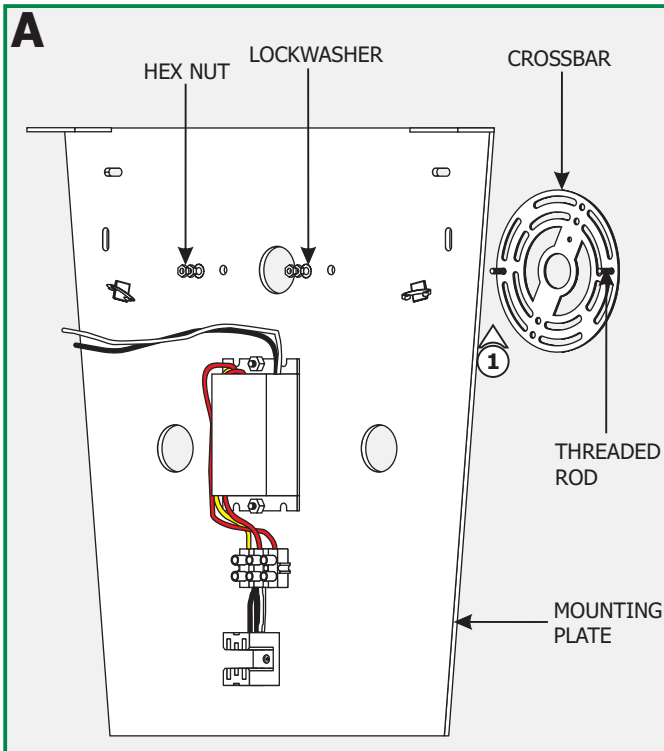

**1:** Loosen the hex nuts and lock washers from the threaded rods on the crossbar and remove the crossbar from the mounting plate.

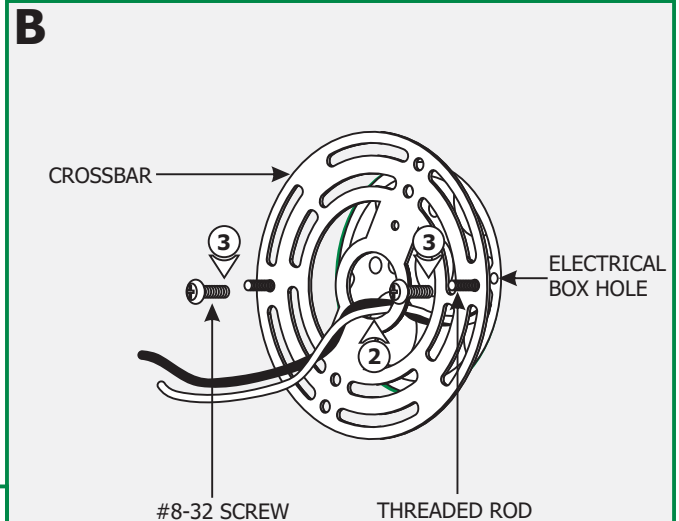

**2:** Feed the power wires through the crossbar center hole.

**3:** Mount the crossbar to the electrical box holes with the provided #8-32 screws. Make sure that the threaded rods on the crossbar are leveled horizontally.

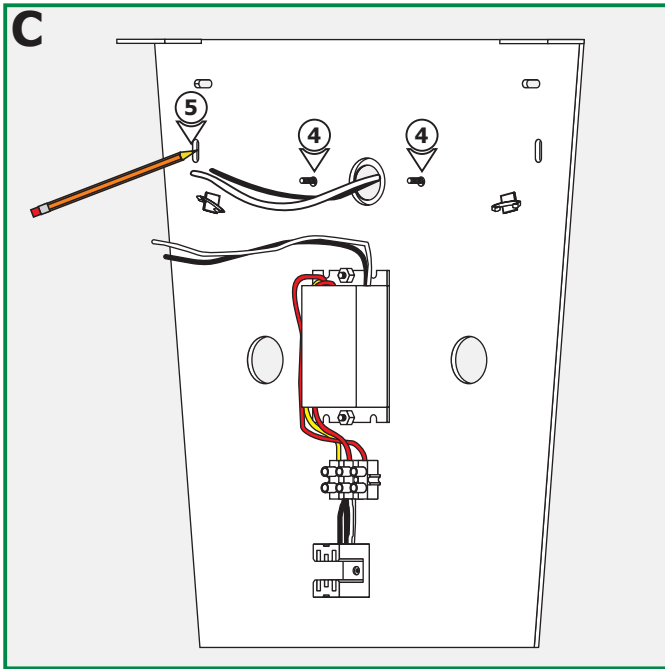

**4:** Feed the power wires through the mounting plate center hole. Align and slide the mounting plate holes onto the crossbar threaded rods.

**5:** Level the mounting plate horizontally and mark the two mounting plate holes onto the wall. These points are used for the anchors.

**6:** Remove the mounting plate.

**7:** Tap the anchors onto the marked points up to the threaded portion with a hammer.

**8:** Screw in the threaded portion of the anchors with a Phillips screwdriver.

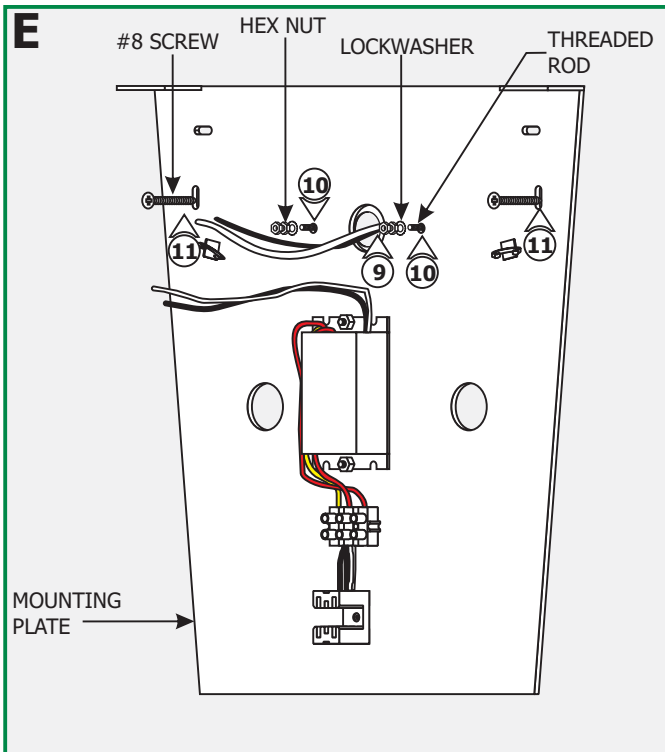
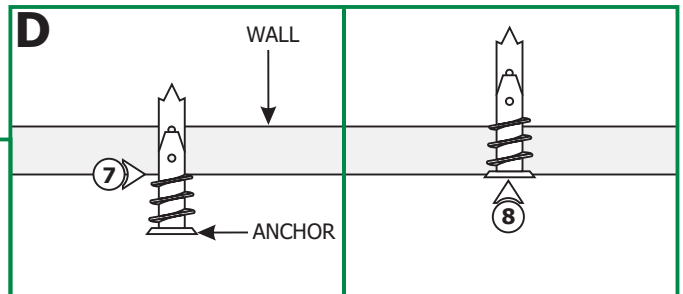

**9:** Feed the power wires through the mounting plate center hole and slide the mounting plate onto the threaded rods.

**10:** Secure the mounting plate to the crossbar assembly by tightening the hex nuts and lock washers.

**11:** Secure the mounting plate to the anchors with the two #8 screws.

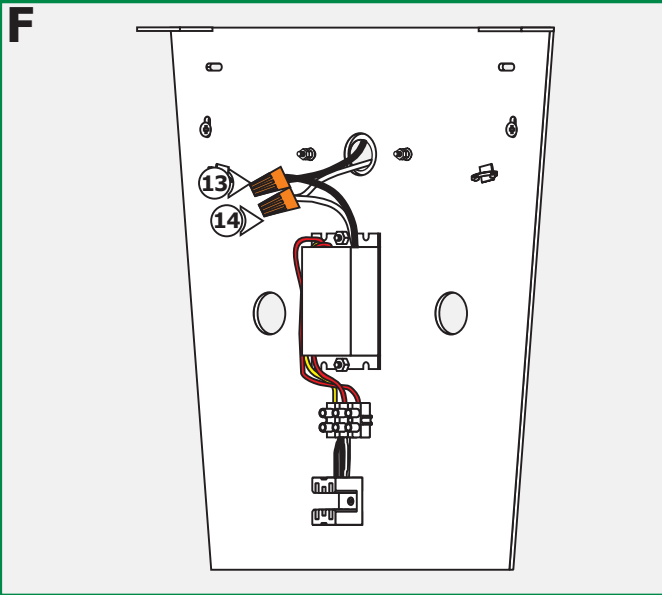

**12:** Make sure that the mounting plate is grounded in accordance with local electrical codes.

**13:** Connect the white fixture wire to the neutral power wire with a wire nut.

**14:** Connect the black fixture wire to the hot power wire with a wire nut.

**CAUTION:** To reduce risk of a burn or electrical shock during lamping, disconnect the power to the fixture.

Use **MAX 40** Watt Type Circline 4-pin T5 2GX13 Base Fluorescent Lamp.



**15:** Insert the lamp pins into the socket slots and secure it in place snapping into the spring clips.

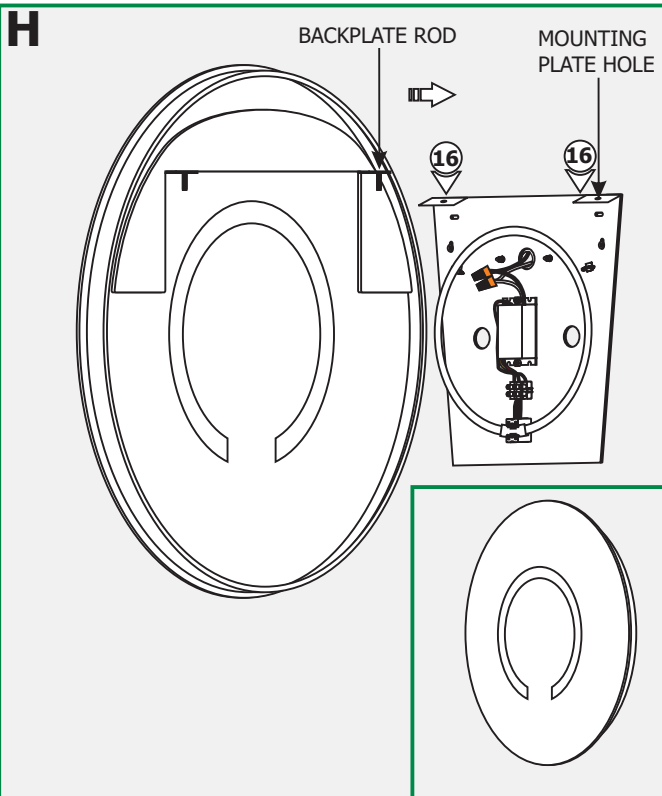
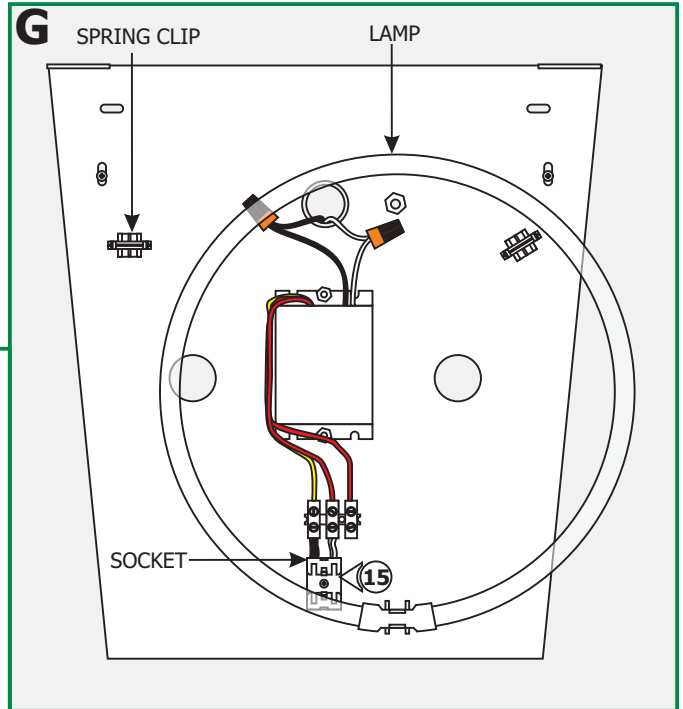

**16:** Hook the mirror backplate rods into the mounting plate holes.