

ATLAS LED



1. Active Cooler
2. Aluminum Heat Sink & Driver (not shown)
3. Thermal Pad
4. LED Array: (Qty 9) 2.4W each
3116K, 85CRI, Approximately 664 Delivered Lumens with 21,617 candelas at 8°
5. 8° Clear Lens Assembly
6. 14°, 33° or 10x40° Lenses (shown with optional lenses installed)
7. Snoot (not shown) optional

The **LED** (19.2 total watts) lamp is an energy efficient alternative for a 120 watt PAR38 spot or 71 watt MR16 lamp. See p. 201 for Web site verification.



LED FIXTURES

LED (Light Emitting Diode) or SSL (Solid State Lighting)

Advantages when properly designed:

Energy consumption reduced 50% to 82% over an incandescent lamp source

Lamp Life: 50,000 hours average based on 70% lumen maintenance

High color rendering (82 - 94 CRI*)

Warm-White color temperatures with tight *binning**

Superior optical control

Dimmable with specified controls

No UV or IR rays: ideal for artwork, produce and fabrics

LEDs do not contain mercury and are RoHS compliant

Five year warranty on all LED products

Wattage measures energy consumed, lumens measure light produced

Incandescent – 9 lumens per watt

Halogen – 15 to 20 lumens per watt

LEDs – 30 to 90 lumens per watt (with precision beam control)

Fluorescent – 50 to 90 lumens per watt (contains mercury)

Metal Halide – 70 to 90 lumens per watt (contains mercury)

Lumens per watt is just part of the story, for directional lamps (MR16, PARs, etc.), center beam candle power (candela) and footcandles tell the full story. See p. 201 for LED to Halogen Comparison Chart, as well as for website verification.

*See lighting terms and definitions, p. 200-201

A "Lighting Facts Label" verifies data of IESNA LM-79 testing as required by the United States Department of Energy (DOE). LED products featuring this label have been tested by an OSHA-certified test lab and comply with LM-79. In addition, the DOE monitors the accuracy of reported product performance, on a sampling basis, through its CALiPER testing program.

- Light Output/Lumens**
Measures light output. The higher the number, the more light is emitted.
Reported as "Total Integrated Flux (Lumens)" on LM-79 test report.
- Watts**
Measures energy required to light the product. The lower the wattage, the less energy used.
Reported as "Input Power (Watts)" on LM-79 report.
- Lumens per Watt/Efficacy**
Measures efficiency. The higher the number, the more efficient the product.
Reported as "Efficacy" on LM-79 test report.

IESNA LM-79-2008
Industry standardized test procedure that measures performance qualities of LED luminaires and integral lamps. It allows for a true comparison of luminaires regardless of the light source.

Brand & Model Number

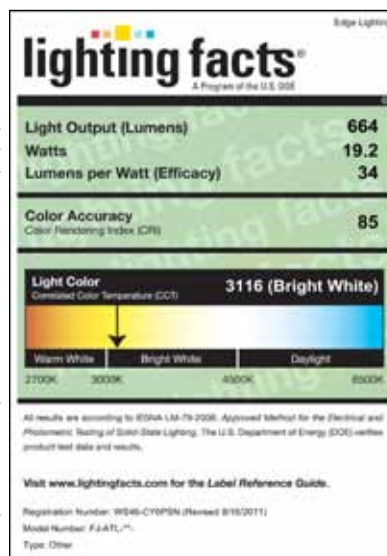

Color Rendering Index (CRI)
Measures color accuracy. Color rendition is the effect of the lamp's light spectrum on the color appearance of objects.

Correlated Color Temperature (CCT)
Measures light color. "Cool" colors have higher Kelvin temperatures (3600–5500K); "Warm" colors have lower color temperatures (2700–3500K).

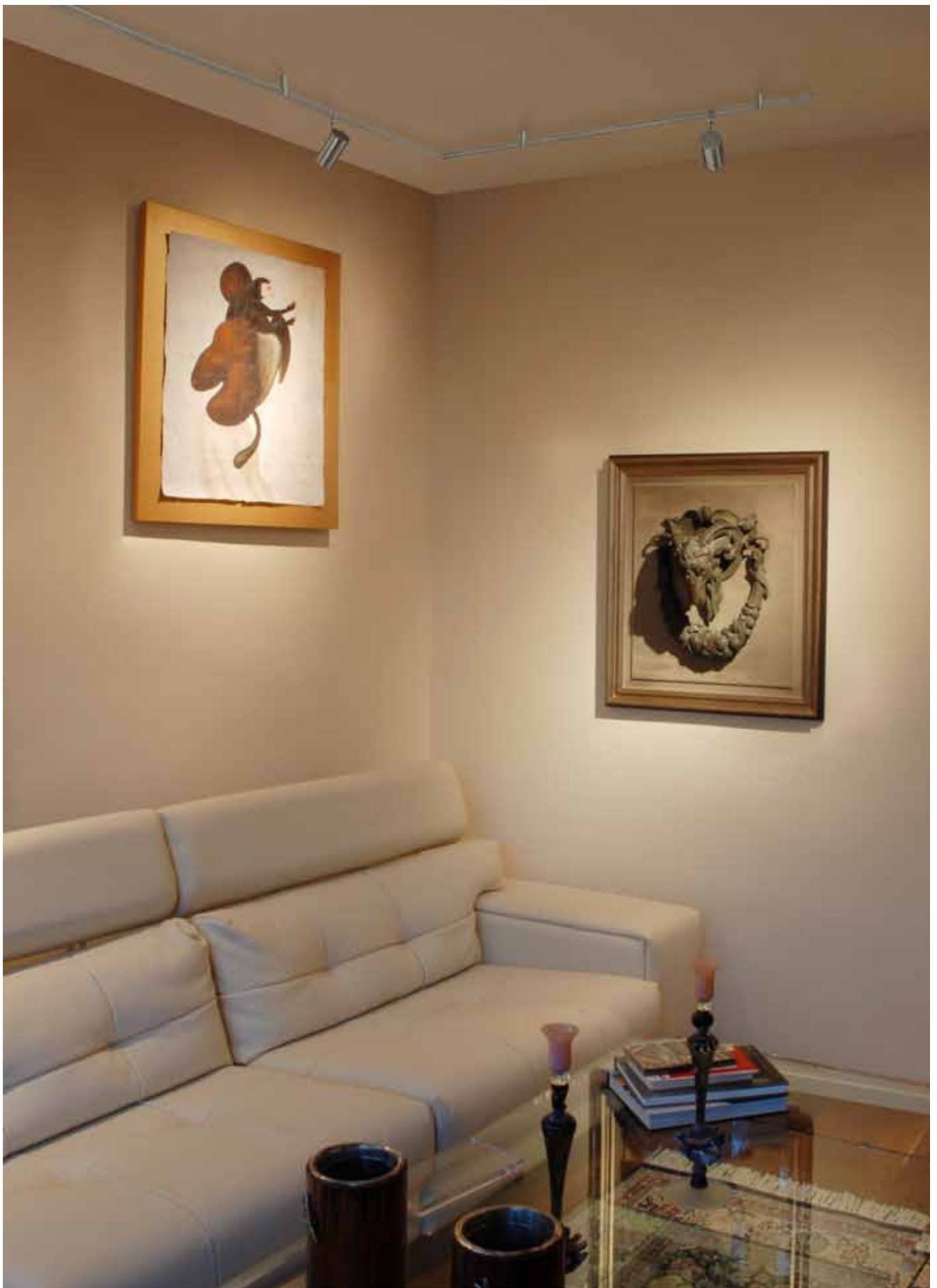

SCOPE LED

Designed by Gregory Kay
Patent Pending



FJ-SCO-1-SN
Satin Nickel
shown with Scope
SCO-A
Accessory

FJ-SCO-1-BZ
Antique Bronze



FJ-SCO-1-PN
Polished Nickel



FJ-SCO-1-WH
White



The Scope **LED**, a classic flat-back cylinder fixture, swivels 90° vertically. The **cool-to-the-touch** rotating lens allows adjustment of the beam angle from a 20° spot to 50° flood while the fixture is lit. Fixture includes 5 year warranty.

SYSTEM	12VAC Monorail (M) or Monorail 2 Circuit (M2)						
COMPATIBILITY	Use Fast Jack (FJ) version for FJ LED canopies (see pp. 91-93)						
HEIGHT	1" (2.5cm)						
FINISH	Satin Nickel, Polished Nickel, Antique Bronze or White						
LAMP SPECIFICATION	12VAC LED , 70% lumen maintenance based on 50,000 hours of operation (see halogen comparison chart on pp. 206-207)						
BEAM SPREAD	LUMENS	WATTS	EQUIVELANT TO HALOGEN MR16	LUMENS PER WATT	CBCP	COLOR TEMP (K)	CRI
20 degrees	217	9.3	30 Watt	23.3	1,739	2,994	83
50 degrees	315	9.3	42 Watt	33.8	596	2,994	83
DIMMING INFORMATION	Dimmable with Lutron Diva or Skylark low voltage dimmers						
OPTICAL ACCESSORIES	SCO-A louver lens holder houses MR16 (L16) lenses, Hexcell Louver and ST-16 Snoot (sold separately on pp. 192-193)						

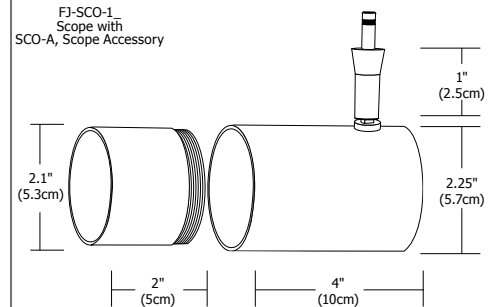

ORDERING CODE	SYSTEM	FIXTURE	HEIGHT	FINISH
FJ	FJ	SCO	1	SN
	Fast Jack Monorail Monorail 2 Circuit	SCO Scope	1 1"	SN Satin Nickel PN Polished Nickel BZ Antique Bronze WH White (only with FJ canopy)



Adjust Beam by turning **LED** Lens

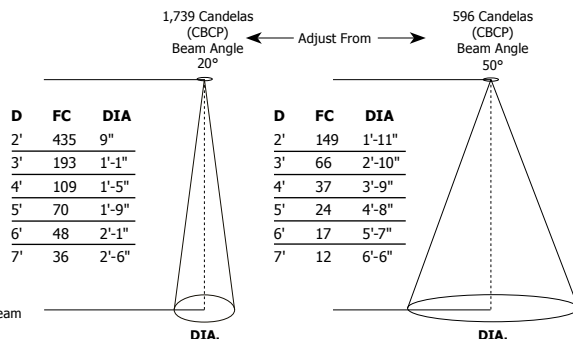

D - Distance from SCOPE **LED** fixture
FC - Initial footcandles at the center of beam
DIA - Diameter

lighting facts

Light Output (Lumens) 315
Watts 9.3
Lumens per Watt (Efficiency) 33
Color Accuracy 83

Light Color 2994 (Warm White)

Visit www.lightingfacts.com for the Label Reference Guide.





CODY LED



FJ-COD-2-SN
Satin Nickel

FJ-COD-2-BZ
Antique Bronze



FJ-COD-2-PN
Polished Nickel

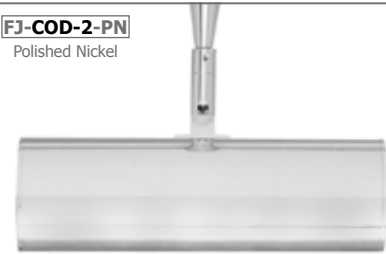

The simple, elegant Cody is a low profile LED wall wash producing uniform, efficient illumination without UV, IR, or the use of mercury. The cool-to-the-touch Cody, with warm-white 2869K high CRI LEDs, consumes low energy and easily replaces the high heat & wattage of incandescent or halogen fixtures. The Cody uses 12 volt AC and dims with a standard low voltage dimmer. Efficient solid state LEDs provide 20 years of efficient light operating at 6 hours per day, reducing the cost of ownership. Fixture includes 5 year warranty.

SYSTEM COMPATIBILITY	12VAC Monorail (M) or Monorail 2 Circuit (M2) Use Fast Jack (FJ) version for FJ LED canopies (see pp. 91-93)
HEIGHT	1.8" (4.6cm)
FINISH	Satin Nickel, Polished Nickel or Antique Bronze
LAMP SPECIFICATION	7.8 total watts 12VAC LED, 2869K, 81CRI, 301 lumens, 70% lumen maintenance based on 50,000 hours of operation
DIMMING INFORMATION	Dimmable with Lutron Diva or Skylark low voltage dimmers

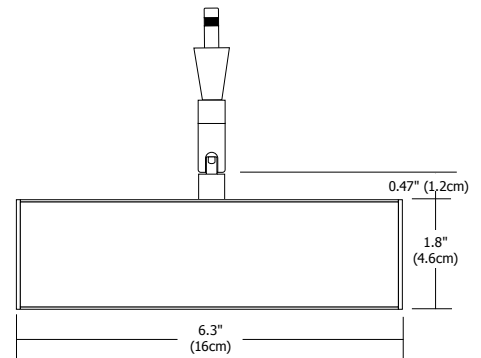
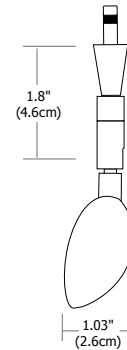

ORDERING CODE	SYSTEM	FIXTURE	HEIGHT	FINISH
FJ	FJ	COD	2	SN
<small>FJ Fast Jack M Monorail M2 Monorail 2 Circuit</small>	<small>FJ Fast Jack M Monorail M2 Monorail 2 Circuit</small>	<small>COD Cody</small>	<small>2 1.8"</small>	<small>SN Satin Nickel PN Polished Nickel BZ Antique Bronze</small>



DISTANCE FROM CEILING	2'			1'		
	2'	1'	1'	1'	1'	1'
0	2	2	2	3	3	3
1'	8	7	8	12	12	12
2'	16	15	16	27	27	27
3'	26	26	26	45	45	45
4'	15	15	15	24	24	24
5'	7	7	7	10	10	10
6'	4	4	4	5	5	5
7'	2	2	2	3	3	3
8'	2	2	2	2	2	2

FOOTCANDLES DISPLAYED AS MEASURED IN LABTEST



ATLAS LED

Designed by
Gregory Kay
& Aaron O'Brien



FJ-ATL-3-SN
Satin Nickel



FJ-ATL-3-BZ
Antique Bronze



FJ-ATL-3-PN
Polished Nickel



FJ-ATL-3-WH
White

Atlas LED presents a high level of accent lighting for retail displays, galleries, museums or offices. Providing uniform illumination without UV, IR or the use of mercury, the 19 watt LED lamp is an energy efficient alternative for a 120 watt PAR 38 Spot or 71 watt MR16 lamp (see p. 173). The cool-to-the-touch fixture allows manual locking of 360° rotation, 90° tilt, and optical lens orientation. The standard version includes an 8° spot lens; additional versions are also available with 14° soft, 33° wide or 10° x 40° linear spread lens. Fixture includes 5 year warranty.

SYSTEM	12VAC Monorail (M) or Monorail 2 Circuit (M2)						
COMPATIBILITY	Use Fast Jack (FJ) version for FJ LED canopies (see pp. 91-93)						
HEIGHT	3.5" (8.9cm)						
FINISH	Satin Nickel, Polished Nickel, Antique Bronze or White						
LAMP SPECIFICATION	12VAC LED, 70% lumen maintenance based on 80,000 hours of operation (see halogen comparison chart on pp. 206-207)						
BEAM SPREAD	LUMENS	WATTS	EQUIVALENT TO HALOGEN PAR38	LUMENS PER WATT	CBCP	COLOR TEMP (K)	CRI
8 degrees	664	19.2	112 Watt	33	21,617	3,116	85
14 degrees	607	19.2	65 Watt	31	6,198	3,116	85
33 degrees	598	19.2	77 Watt	31	1,800	3,116	85
DIMMING INFORMATION	Dimmable with Lutron Diva or Skylark low voltage dimmers						
OPTICAL ACCESSORIES	L30 Lenses: Soft Focus, Wide or Linear Spread, Color Lens with UV Filter, Hexcell Louver or Snoot #ST30 (see pp. 192-193)						

FJ-ATL-3 Standard Version Sold with 1 Lens

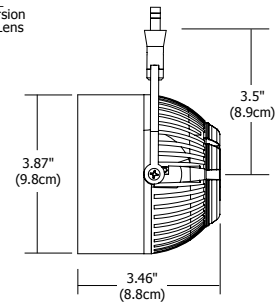

ORDERING CODE	SYSTEM	FIXTURE	HEIGHT	SPREAD LENS	FINISH
FJ	ATL	3	Leave Blank for 8° Spot	SN	
FJ Fast Jack M Monorail M2 Monorail 2 Circuit	ATL Atlas	3 3.5"	SF 14° Soft Focus WD 33° Wide LS 10°x 40° Linear Spread	SN Satin Nickel PN Polished Nickel BZ Antique Bronze WH White (only with FJ canopy)	

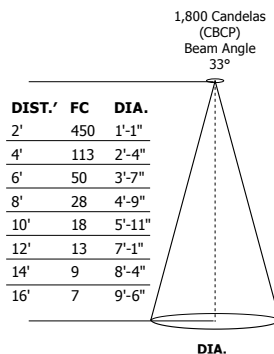
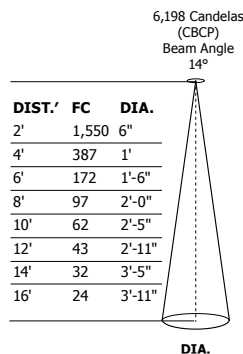
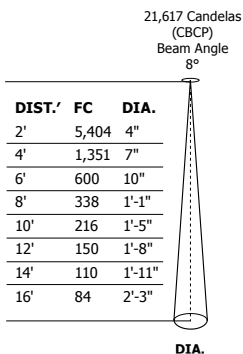



Monorail Circuit
with M-NAU-3-SN and M-ATL-3-SN

NAUTILUS LED

Designed by
Gregory Kay
& Aaron O'Brien
Patent Pending

FJ-NAU-3-SN
Satin Nickel



FJ-NAU-3-BZ
Antique Bronze



FJ-NAU-3-PN
Polished Nickel



FJ-NAU-3-WH
White



Providing uniform direct lighting for vertical surfaces, the Nautilus LED wall wash is ideal for retail displays, galleries, museums or offices, the fixture provides efficient illumination without UV, IR or the use of mercury. The **cool-to-the-touch** fixture allows manual locking of 360° rotation and 180° tilt to evenly wash a wall up to 4' (1.2m) wide from a 2' (0.6m) distance. Fixture includes 5 year warranty.

SYSTEM 12VAC Monorail (M) or Monorail 2 Circuit (M2)
COMPATIBILITY Use Fast Jack (FJ) version for FJ LED canopies (see pp. 91-93)

HEIGHT 3" (7.6cm)

FINISH Satin Nickel, Polished Nickel, Antique Bronze or White

LAMP SPECIFICATION 34.8 total watts 12VAC LED, 2949K, 84CRI, 782 lumens, 70% lumen maintenance based on 50,000 hours of operation

DIMMING INFORMATION For up-to-date dimming information, visit www.edgelighting.com.

ORDERING CODE	SYSTEM	FIXTURE	HEIGHT	FINISH
FJ	NAU	3	SN	
FJ Fast Jack M Monorail M2 Monorail 2 Circuit	NAU Nautilus	3 3"	SN Satin Nickel PN Polished Nickel BZ Antique Bronze WH White (only with FJ canopy)	

FJ-NAU-3_

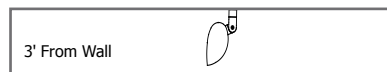
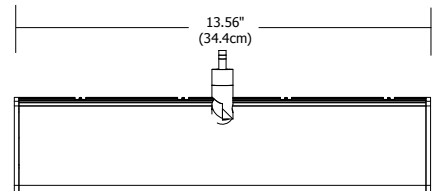
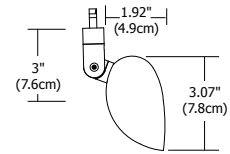

DISTANCE FROM CEILING	2'		3'	
	0	1	0	1
0	40	38	40	32
1	109	99	109	89
2	80	76	80	60
3	45	44	45	33
4	27	26	27	19
5	16	16	16	12
6	10	10	10	8
7	6	6	6	5
8	5	5	5	4

FOOTCANDLES DISPLAYED AS MEASURED IN LAB TEST

DISTANCE FROM CEILING	3'		4'	
	0	1	0	1
0	20	19	20	17
1	45	41	45	38
2	49	45	49	41
3	33	32	33	27
4	23	22	23	18
5	16	16	16	13
6	11	11	11	9
7	8	8	8	6
8	6	6	6	5

FOOTCANDLES DISPLAYED AS MEASURED IN LAB TEST



2009 AWARD
NEXT GENERATION
LUMINAIRES